

THESE DRAWINGS AND SPECIFICATIONS ARE THE PROPERTY OF JBL INCORPORATED. THEY ARE ISSUED IN STRICT CONFIDENCE AND SHALL NOT BE REPRODUCED OR USED AS THE BASIS FOR MANUFACTURE OR APPARATUS WITHOUT WRITTEN PERMISSION.

ALL MATERIAL SPECIFIED ON THIS DRAWING SHALL COMPLY WITH EUROPEAN DIRECTIVE 2002/95/EC. **RoHS**

REVISIONS						
CHG	LTR	DESCRIPTION	DRFT	D.C	DATE	APPR
35674	A	RELEASE TO MARKETING	TH			<i>R</i>

2/14/08

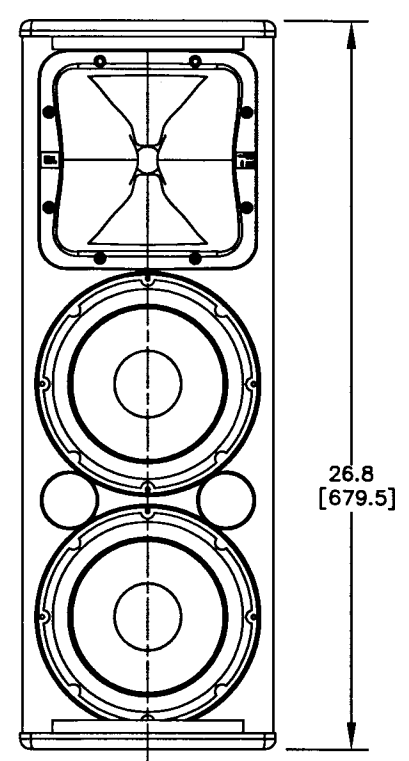
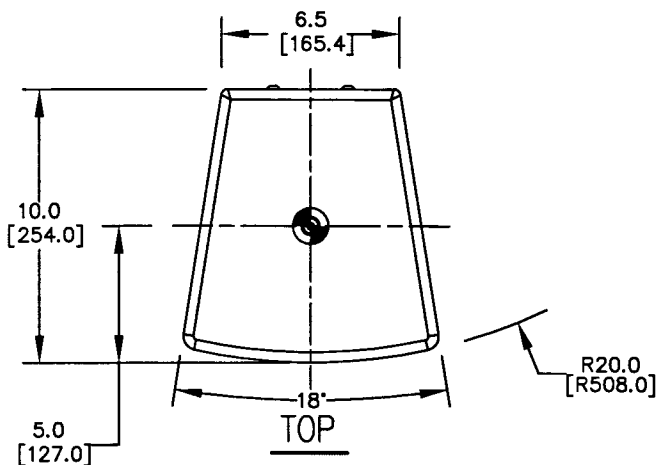

FRONT

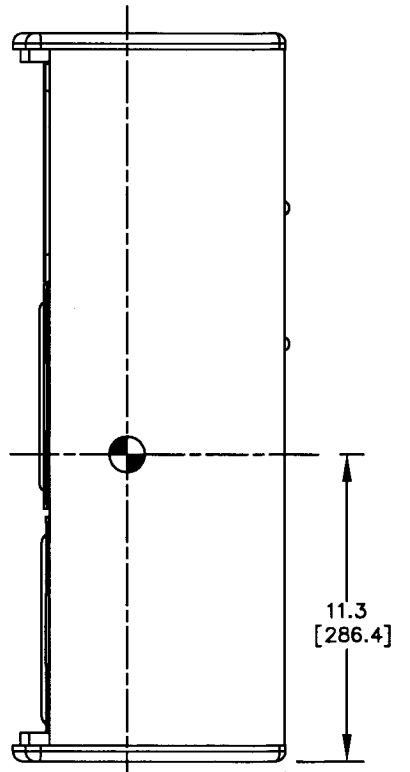

SIDES

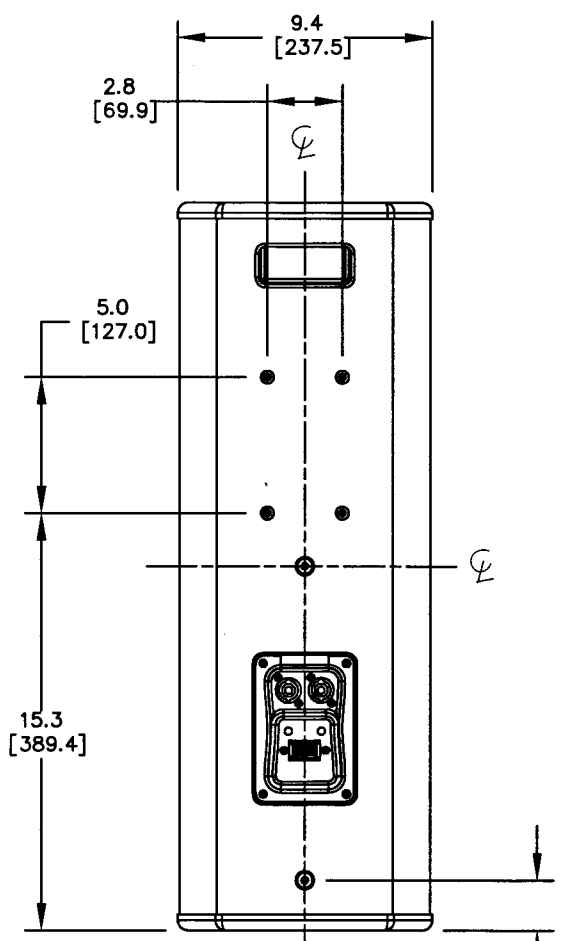

REAR

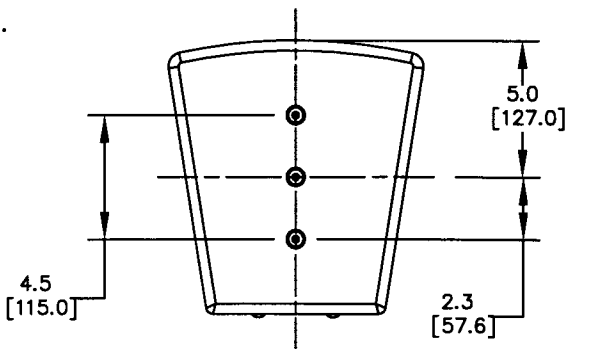

BOTTOM

- COMPONENTS: LF - 2X 228J 8" DIA. WOOFER  
HF - 1X 2408H-1 COMPRESSION DRIVER  
1X PT-D95HF-1 (90° X 50°) WAVEGUIDE  
OR 1X PT-D126HF-1 (120° X 60°) WAVEGUIDE
- INPUT CONNECTORS: 2 NEUTRIK NL4 CONNECTORS AND 1 BARRIER STRIP TERMINAL BLOCK, ALL 3 CONNECTED IN PARALLEL.
- OPERATING MODE: FULLY PASSIVE CROSSOVER  
INTERNAL SELECTOR ON INPUT CUP FOR OPTIMIZED PERFORMANCE IN HORIZONTAL OR VERTICAL ORIENTATION.
- GRILLE: 16 GA. PERFORATED CRS, POWDER COATED BLACK WITH BLACK FOAM BACKING AND ROTATABLE LOGO. (NOT SHOWN)
- MATERIALS: 12MM (.47") HARDWOOD PLYWOOD.  
TOP/BTM PANEL 15MM (.59") HARDWOOD PLYWOOD.
- FINISH: BLACK DURAFLEX (WHITE AVAILABLE )
- WEIGHT: 18.6 Kg (40.9 LBS).
- INDICATES CENTER OF GRAVITY (CG) ●
- SUSPENSION POINTS "•" 10 TOTAL:  
1 EA M8 THREAD PATTERN - TOP PANEL  
3 EA M8 THREAD PATTERN - BTM PANEL  
6 EA M8 THREAD PATTERN - REAR PANEL

NOTES: (UNLESS OTHERWISE SPECIFIED)

**TOLERANCES**  
(UNLESS OTHERWISE SPECIFIED)  
X.XX ± .063 INCH  
X.X ± .125 INCH  
ANGULAR TOLERANCE OF 0°±30'  
FRACTIONAL DIMENSIONS ± 1/32  
• DIMENSIONS ARE INCHES  
• ALL DIMENSIONS ARE FINISHED DIMENSIONS  
• DO NOT SCALE DRAWING

<b>JBL</b> JBL PROFESSIONAL A Harman International Company Northridge, California 91329 U.S.A.		
TITLE CUSTOMER DRAWING: AC28/95, AC28/26		
SIZE A	DRAWING NO. 365220	REV A
SCALE NTS		SHEET 1 OF 1